

Short and Sunny Pollinator Garden - Natural Design

Buy Plants at: www.blazingstargardens.com

Design Tips:

- Don't worry about copying the design exactly!
- These plants move and spread naturally and this mixed-up "natural" design reflects that
- **Focus on heights—short plants towards borders, tall plants towards the middle/back**
- Roughly 12 - 15" spacing for all plants and no straight lines is easiest
- Dig all holes first to establish spacing, then lay out plants
- ***Not shown in design:* Scatter grasses and sedges throughout the garden or plant in groups of 3**

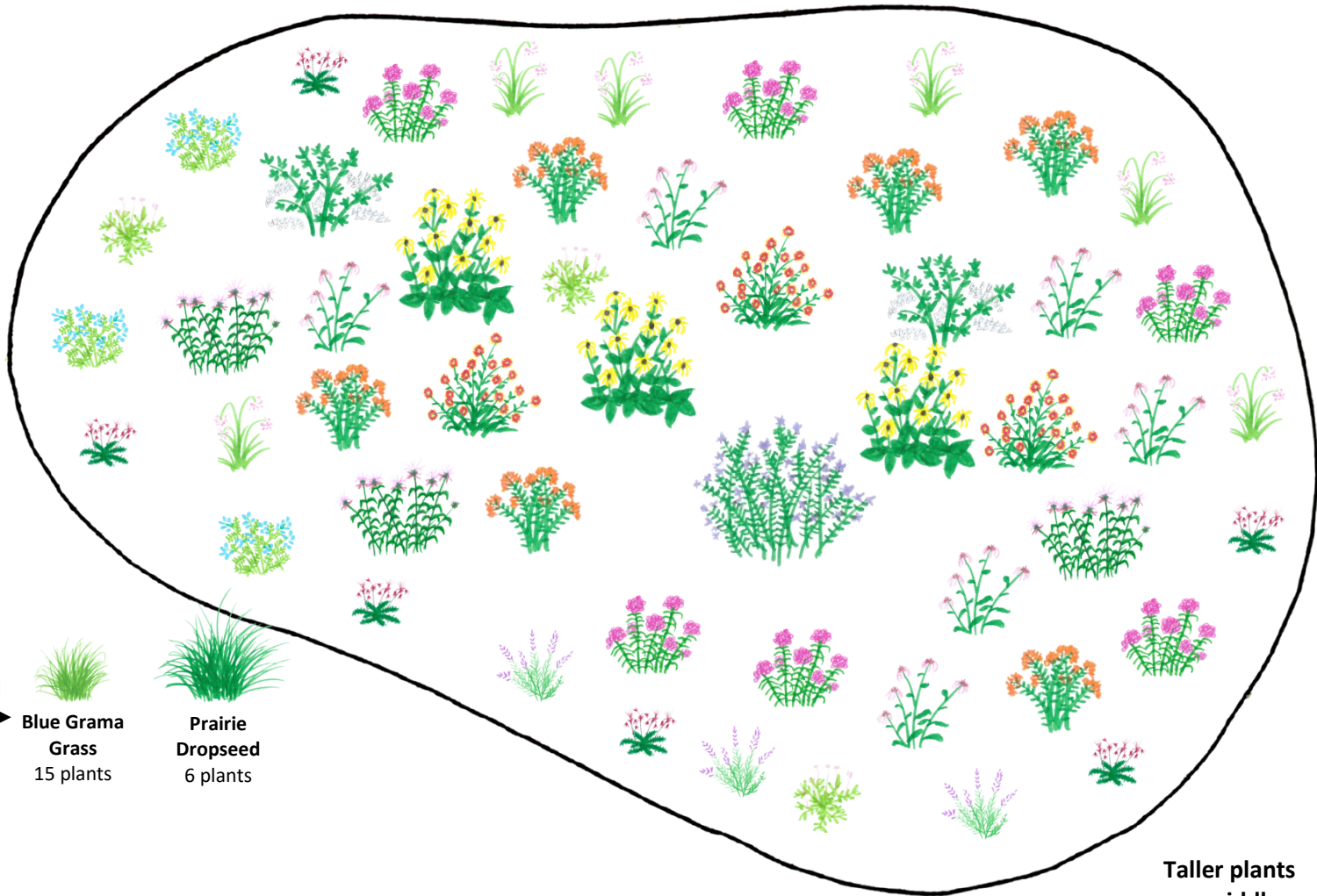

Blue Grama Grass 15 plants
 Prairie Dropseed 6 plants

Shorter plants near borders or front of garden

Prairie Smoke 6 plants
 Pussytoes 3 plants

Jacob's Ladder 3 plants

Dotted Blazing Star 3 plants

Nodding Onion 6 plants

Prairie Phlox 6 plants

Bradbury's Monarda 3 plants

Butterfly Milkweed 6 plants

Narrow Leaf Coneflower 6 plants

Blanket Flower 3 plants

Cream Wild Indigo 2 plants

Aromatic Aster 1 plant
 (this plant spreads)

Orange Coneflower 3 plants

Plant by Height:

Taller plants near middle or back of garden



Short and Sunny Pollinator Garden - Traditional Design

Buy Plants at: www.blazingstargardens.com

Design Tips:

- Don't worry about copying the design exactly!
- This design has the plants in more "traditional" groups of plants
- **Focus on heights—short plants towards borders, tall plants towards the middle/back**
- Roughly 12 - 15" spacing for all plants and no straight lines is easiest
- Dig all holes first to establish spacing, then lay out plants
- ***Not shown in design:* Scatter grasses and sedges throughout the garden or plant in groups of 3**

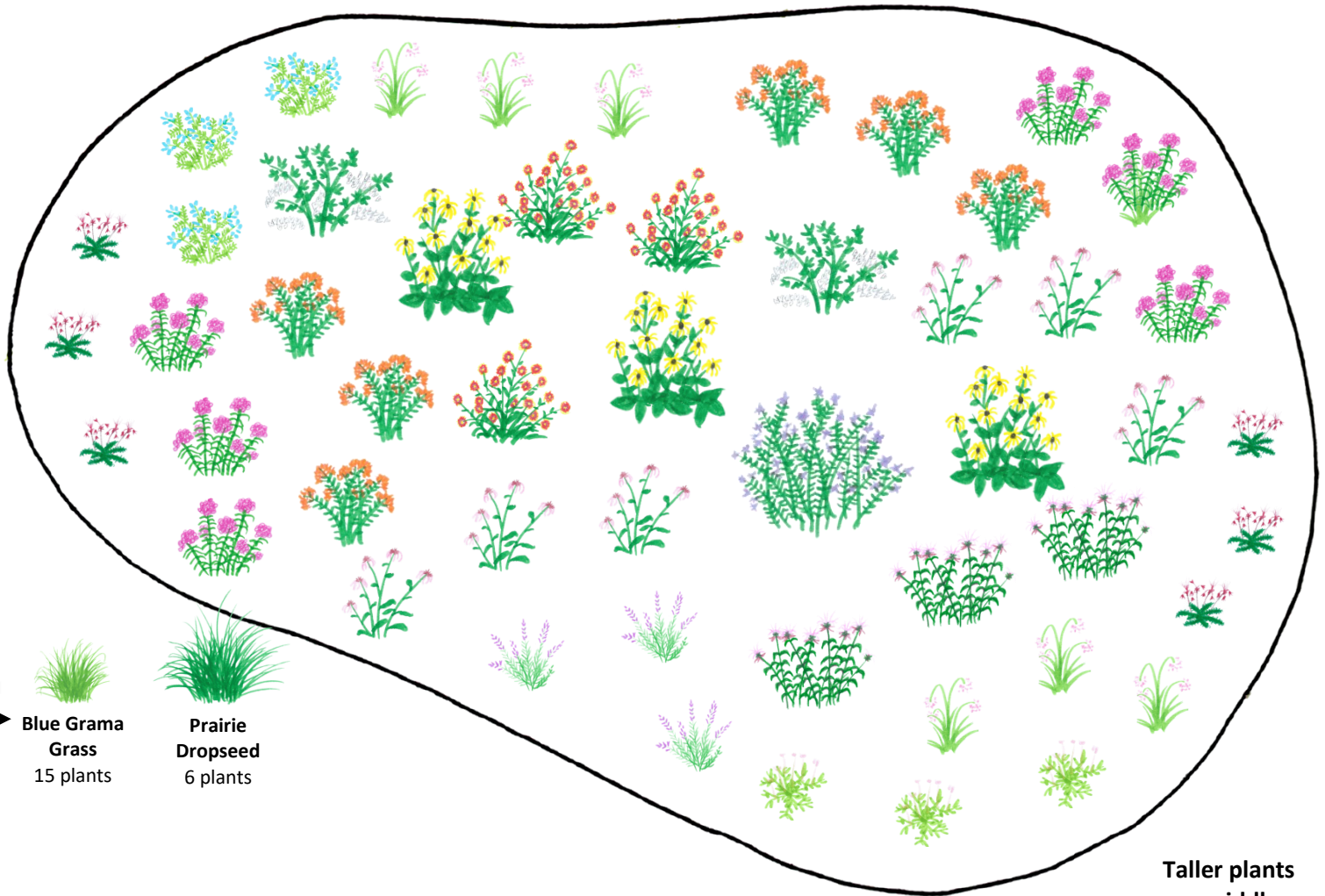













Blue Grama Grass
15 plants

Prairie Dropseed
6 plants

Shorter plants near borders or front of garden

Plant by Height:

Taller plants near middle or back of garden

- | | | | | | | | | | | | | |
|--|---|---|---|---|---|--|---|---|---|---|---|---|
|  |  |  |  |  |  |  |  |  |  |  |  |  |
| Prairie Smoke
6 plants | Pussytoes
3 plants | Jacob's Ladder
3 plants | Dotted Blazing Star
3 plants | Nodding Onion
6 plants | Prairie Phlox
6 plants | Bradbury's Monarda
3 plants | Butterfly Milkweed
6 plants | Narrow Leaf Coneflower
6 plants | Blanket Flower
3 plants | Cream Wild Indigo
2 plants | Aromatic Aster
1 plant
(this plant spreads) | Orange Coneflower
3 plants |

Planting and Maintenance Instructions

This is a summary. View detailed step-by-step pictures and instructions at: www.blazingstargardens.com/how-to-make-a-pollinator-garden

Planting Instructions:

1. **Find a well-drained spot** with sunny conditions—at least 4-6 hours of direct sunlight a day.
2. **Remove existing grass/weeds. This is very important.** You can remove the lawn (shovel or rent a sod cutter). **Or** you can smother it with thick paper rolls or cardboard along with 3" of mulch on top for **at least 2 months** before planting (do this in **February or March** to prepare for a May planting). **Or** you can apply a grass remover and wait two weeks before mulching and planting. Tilling will not kill grass or weeds. Mulching at time of planting will not kill grass.
3. **Add edging** (optional, but recommended). 5" deep plastic edging is best for keeping out weeds and lawn grass that creep underground. Blocks look nicer but grass will creep through the cracks. If using blocks, put a plastic barrier on the front grass edge of the block and underneath at least 1ft into the garden.
4. **Add 3" of wood mulch** (optional, but highly recommended). Do it before or after planting. Buy bags or get bulk mulch delivered. If you stay on top of weeding (weed often and when weeds are small; big weed roots tear up the mulch layer when pulled), you won't have to add mulch again.
5. **Dig holes to establish spacing.** We recommend spacing all plants 12-15" apart.

**** Don't rip the plants up and out of the pots! Instead, cup the top of the plant soil in your hand, flip the pot over, and lightly squeeze the root ball out. ****

6. **Plant your plants.** Lay out plants, and then plant them level with the ground. Then—and this is important—push some soil on top of the potting soil to seal in moisture, and put the mulch right against the plant.
7. **Water *immediately* afterwards.** Really soak them with a wand or nozzle to muddy the soil tightly around the plant. Don't use a sprinkler for this step.
8. **Water every 2-3 days for 6 weeks** (unless it rains 1" or more). Always watch for wilting. Don't water every day, and don't water if they don't need it—watering too often can rot and kill plants. When you water, use a wand and make sure to repeatedly soak each plant 2 or 3 times—dry potting soil takes a long time to soak up water. After a month of watering, you might only need to water a few more times if you have mulch and good rainfalls.

Maintenance Instructions:

1. **Weed at least once a month.** It's much easier to tell the difference between a weed and your new plants when the weeds have just sprouted--because the weeds will be tiny random sprouts, and the native plants will be in bigger clumps and evenly spaced. We like to walk our new gardens every few days, doing a little at a time, starting to recognize the native plants and the common weeds, and watching the garden grow. Once the weeds get to be the same size as the native plants it is much more difficult to tell the difference. When weeds get big their roots start ruining the mulch layer when they get pulled.
2. **Trim the plants in the spring or fall, or don't**--it's your decision. We like to trim and leave the trimmings on the garden, sometimes in fall, sometimes in spring, and sometimes—if they garden looks ok in fall—we don't trim at all. But again, it's up to you. You don't have to do the same maintenance every year!